

SEH1™ / SEA2™ / SET2™

Single Exotic Alloy Mechanical Seal with Flush

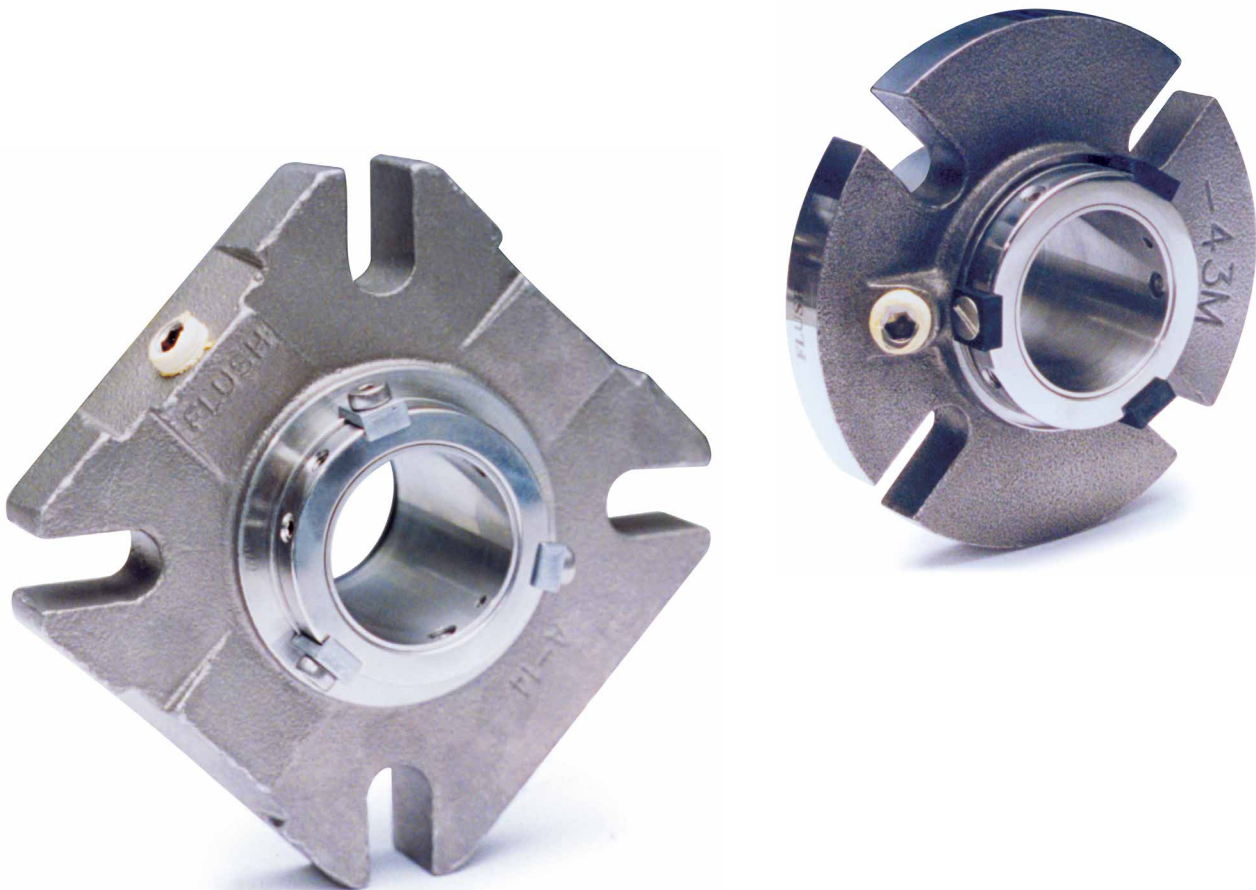

- Solid Exotic Alloy Cartridge Seal Range Offered in Alloy 20 or Alloy 276 Titanium Grade 2
- Solid Exotic Alloy Gland with Integral Flush
- Cartridge Designs Factory Assembled and Tested

Standard Box Bore Single Mechanical Seal

SEA2™ / SEH1™ Standard / ANSI Box Bore

The SEA2™ and SEH1™ range of cartridge mechanical seals are specifically designed for the Chemical Industry.

This exotic alloy seal range, offered in Standard and ANSI+ gland configurations, are offered in solid Alloy 20 and Alloy 276 materials.

This inventoried seal range is therefore an ideal solution for some chemical applications, which require a single seal with process fluid flush.

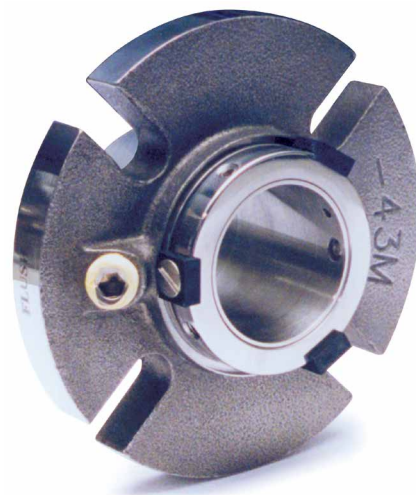

Standard SEA2™ / SEH1™ - Dimensional Information (inches)

A	B	C	E	F Min	F Min†	F Max	G Min	G Max	H Max	I	J	K Max
1.125	4.250	2.312	0.492	1.750	1.790	2.062	2.875	3.750	1/2	1.055	1.354	0.040
1.375	4.375	2.625	0.492	2.000	2.040	2.250	3.125	3.875	1/2	1.055	1.354	0.040
1.750	5.250	3.000	0.644	2.500	2.540	2.625	3.562	4.750	1/2	1.090	1.393	0.040
1.875	5.500	3.312	0.644	2.625	2.665	3.000	3.875	5.000	1/2	1.090	1.393	0.040
2.125	5.750	3.687	0.644	2.875	2.915	3.312	4.375	5.125	5/8	1.150	1.413	0.040
2.500	6.250	4.187	0.644	3.375	3.435	3.687	4.875	5.625	5/8	1.199	1.413	0.060
2.625	6.250	4.187	0.644	3.500	3.560	3.750	4.875	5.625	5/8	1.199	1.413	0.060

Minimum bolt circle based on bolt size shown. † = F Min + K Max

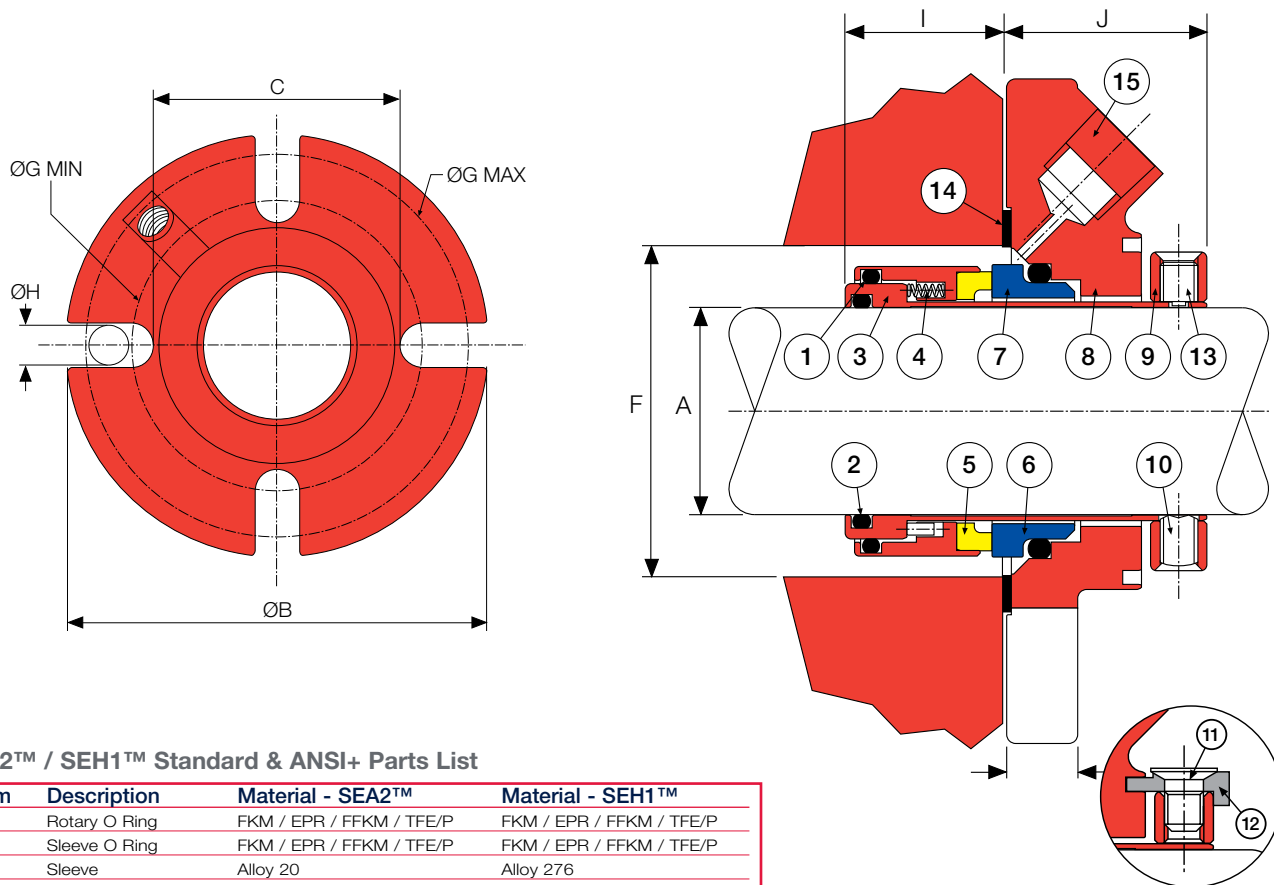

SEA2™ / SEH1™ Standard & ANSI+ Parts List

Item	Description	Material - SEA2™	Material - SEH1™
1	Rotary O Ring	FKM / EPR / FFKM / TFE/P	FKM / EPR / FFKM / TFE/P
2	Sleeve O Ring	FKM / EPR / FFKM / TFE/P	FKM / EPR / FFKM / TFE/P
3	Sleeve	Alloy 20	Alloy 276
4	Springs	Alloy 276	Alloy 276
5	Rotary Face	Alloy 20 - Carbon / TC / SiC	Alloy 276 - Carbon / TC / SiC
6	Stationary Face	TC / Ceramic / SiC	TC / Ceramic / SiC
7	Stationary O Ring	FKM / EPR / FFKM / TFE/P	FKM / EPR / FFKM / TFE/P
8	Gland	Alloy 20	Alloy 276
9	Clamp Ring	Alloy 20	Alloy 276
10	Drive Screws	Alloy 20	Alloy 276
11	Clip Screws	Stainless Steel	Stainless Steel
12	Setting Clips	Hard Plastic / Metal	Hard Plastic / Metal
13	Anti-tamper Screws	Stainless Steel	Stainless Steel
14	Gasket	AF1 / GFT	AF1 / GFT
15	1/4" NPT Port Plug	Alloy 20	Alloy 276

Large / ANSI+ Box Bore Single Mechanical Seal

SEA2™ / SEH1™ ANSI+ / Large Box Bore

- Single cartridge seal with Alloy 20 or Alloy 276 components
- Balanced seal faces
- Springs out of the product
- Offered in standard box and large box gland configurations

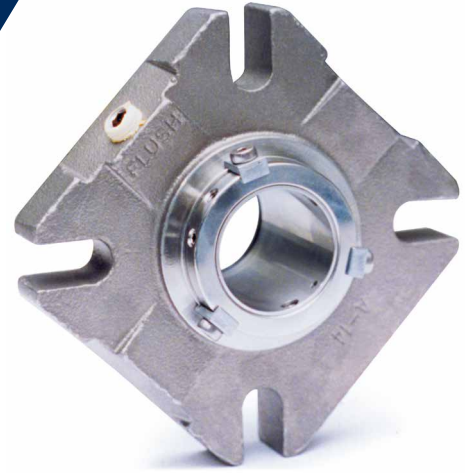

ANSI+ SEA2™ / SEH1™ - Dimensional Information (inches)

A	B	C	E	F Min	F Max	G Min	G Max	H Max	I	J	K Max	L
1.125	5.000	3.188	1.000	2.625	2.850	3.750	4.250	0.500	0.805	1.604	0.040	3.990
1.375	5.375	3.438	1.000	2.875	3.100	4.000	4.625	0.500	0.981	1.429	0.040	4.240
1.750	6.750	4.438	0.644	3.500	4.100	5.000	6.000	0.500	0.842	1.640	0.040	5.480
1.875	6.750	4.438	0.644	3.625	4.100	5.000	6.000	0.500	0.847	1.640	0.040	5.480
2.125	7.625	4.688	0.644	3.875	4.225	5.375	6.687	0.625	0.920	1.640	0.040	6.230
2.500	8.250	5.438	0.644	4.500	5.100	6.125	7.312	0.625	0.755	1.857	0.060	6.730
2.625	8.250	5.438	0.644	4.625	5.100	6.125	7.312	0.625	0.755	1.857	0.060	6.730

Minimum bolt circle based on bolt size shown.

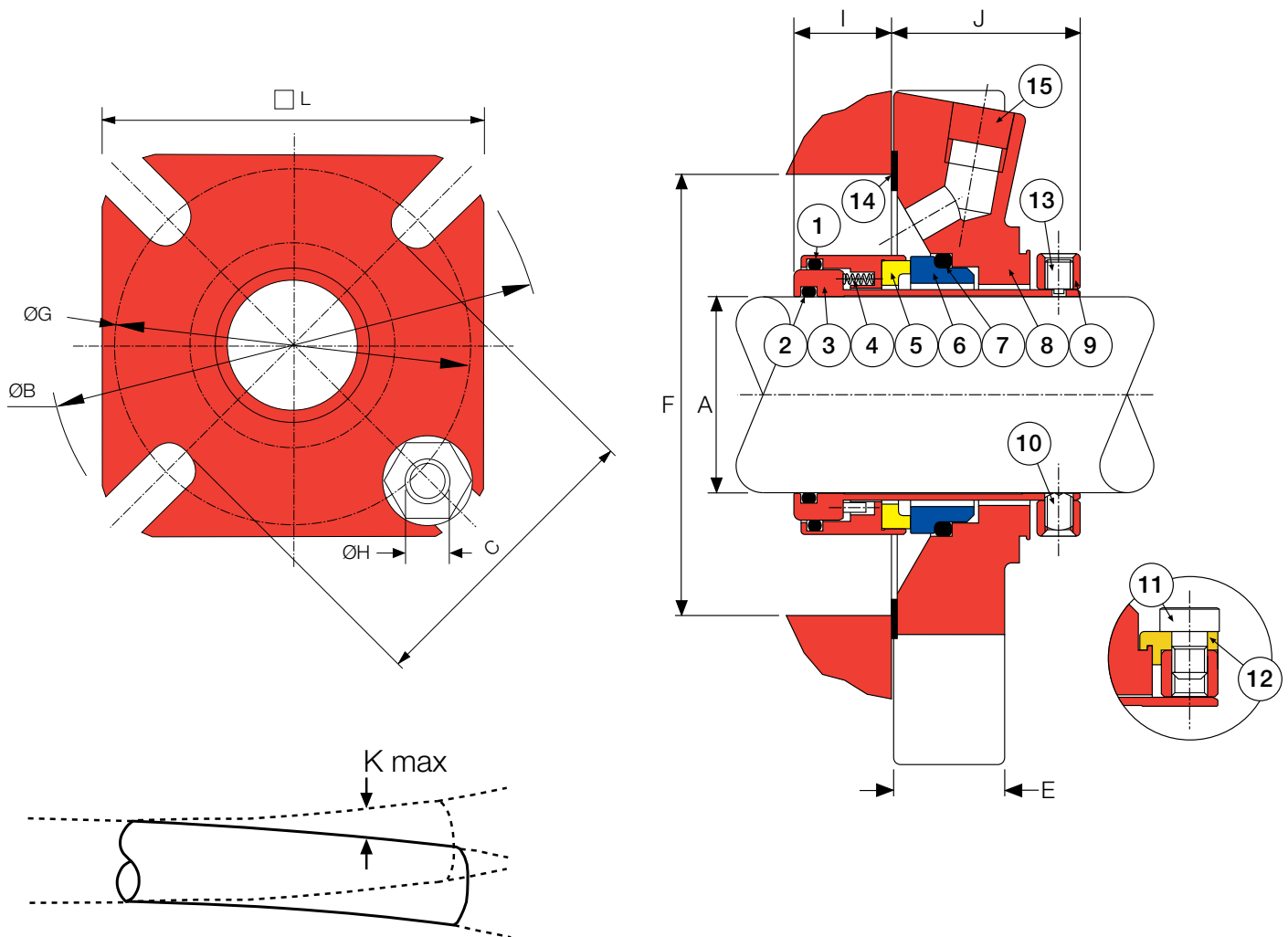

K Max = MAXIMUM TOTAL RADIAL MOVEMENT.

SET2 Cartridge Mechanical Seal

SEAL SIZE	A (min)	B*
24mm - 35mm	18.6mm	34.6mm
38mm - 50mm	20.2mm	35.6mm
53mm - 60mm	19.2mm	36.1mm
63mm - 70mm	21.4mm	36.1mm
1.000" - 1.375"	0.732"	1.362"
1.500" - 1.875"	0.796"	1.401"
2.000" - 2.375"	0.755"	1.422"
2.500" - 2.750"	0.843"	1.421"

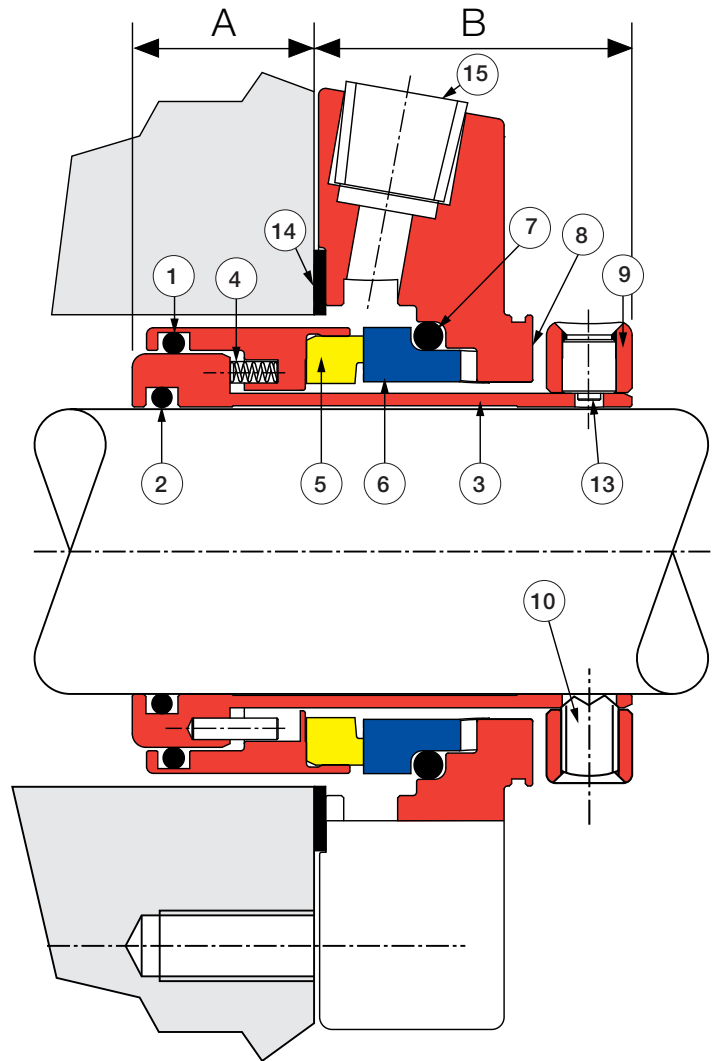
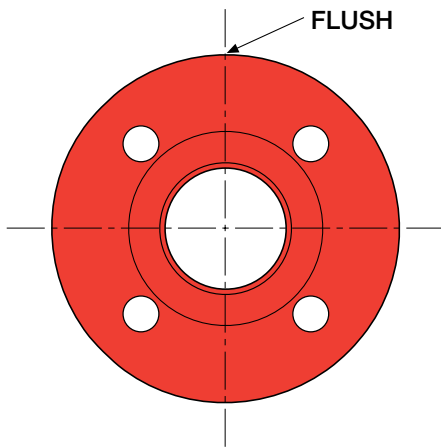

Item	Description	Material
1	Rotary O Ring	FKM / EPR / FFKM / TFE/P
2	Sleeve O Ring	FKM / EPR / FFKM / TFE/P
3	Sleeve	Titanium Grade 2
4	Springs	Alloy 276
5	Rotary Face	Titanium Grade 2 - Carbon / TC / SiC
6	Stationary Face	TC / Ceramic / SiC
7	Stationary O Ring	FKM / EPR / FFKM / TFE/P
8	Gland	Titanium Grade 2
9	Clamp Ring	Titanium Grade 2
10	Drive Screws	Titanium Grade 2
11	Clip Screws	Stainless Steel
12	Setting Clips	Hard Plastic / Metal
13	Anti-tamper Screws	Stainless Steel
14	Gasket	GFT
15	1/4" NPT Port Plug	Titanium Grade 2

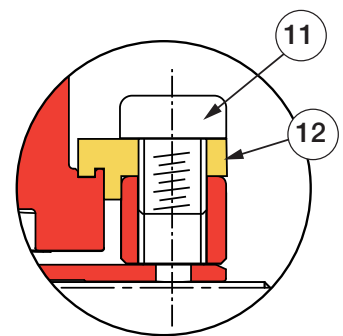

Other Cartridge Seals for the Chemical Industry

AESSEAL® offer a wide range of products for the chemical and associated industries. Some of these innovative products are shown below.

- Extensive inventory of exotic alloy components including Titanium, Alloy 20, Alloy 276 and Alloy 400
- Modular designs

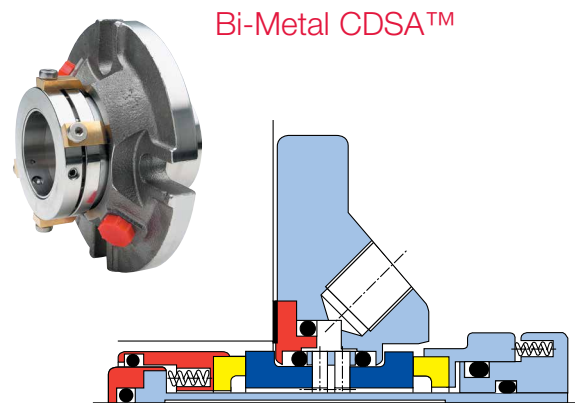
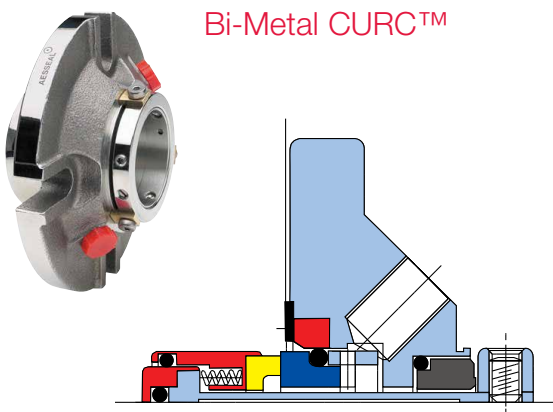

World leading patented technology in exotic alloy wetted mechanical seals.

- Mechanical seals inventoried for P.F.A. lined and other non-metallic pumps
- Cartridge design for reliable installation
- Optional high purity wetted perfluoroelastomers

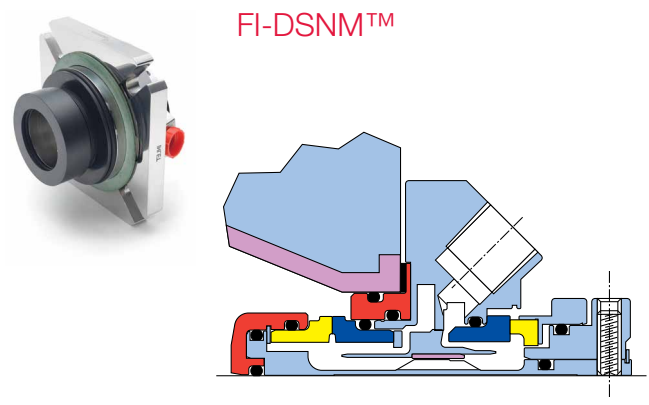
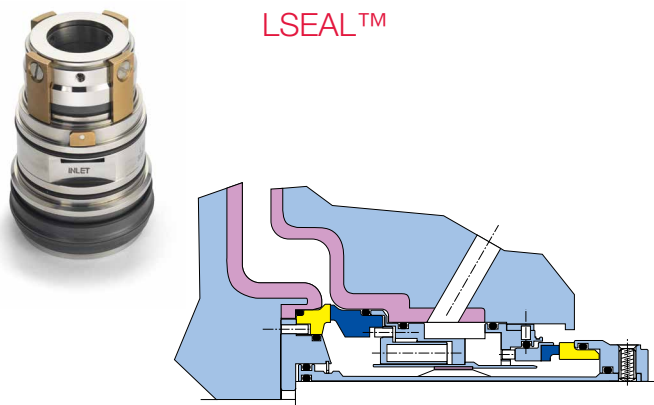

“ Our purpose is to give our customers such exceptional service that they need never consider alternative sources of supply. ”



ENVIRONMENTAL TECHNOLOGY

To experience the exceptional, please contact your local representative. Discover full details on our website:

www.aesseal.com

This brochure is fully recyclable. When laminated, a sustainable, biodegradable and recyclable lamination is used.

For further information and safe operating limits contact our technical specialists at the locations below.



AESSEAL plc is certified to:

ISO 9001, ISO 14001, ISO/IEC 20000, ISO/IEC 27001,
ISO/TS 29001, ISO 37001, ISO 45001 & ISO 50001

Use double mechanical seals with hazardous products.

Always take safety precautions:

- Guard your equipment
- Wear protective clothing



UK Sales & Technical advice:

AESSEAL plc
Mill Close
Bradmarsh Business Park
Rotherham,
S60 1BZ, UK
Tel: +44 (0) 1709 369966
E-mail: enquiries@aesseeal.info
www.aesseal.com



Net Zero champions globally



USA Sales & Technical advice:

AESSEAL Inc.
355 Dunavant Drive
Rockford,
TN. 37853,
USA
Tel: +1 865 531 0192
E-mail: inquiries@aesseeal.us
www.aesseal.us

Important: Since the conditions and methods of use of this product are beyond our control, AESSEAL plc expressly disclaims any and all liability resulting or arising from any use of this product or reliance on any information contained in this document - AESSEAL plc standard conditions of sale apply. All sizes are subject to manufacturing tolerances. We reserve the right to modify specifications at any time. AESSEAL® is a Registered Trademark of AES Engineering Ltd, AESSEAL plc recognizes all trademarks and trademark names as the property of their owners.