

SECTION A-A

8.189 (208.00mm) PCD
 8 OFF HOLES Ø13mm THRU' EQUI-SPACED ON PCD AS SHOWN.

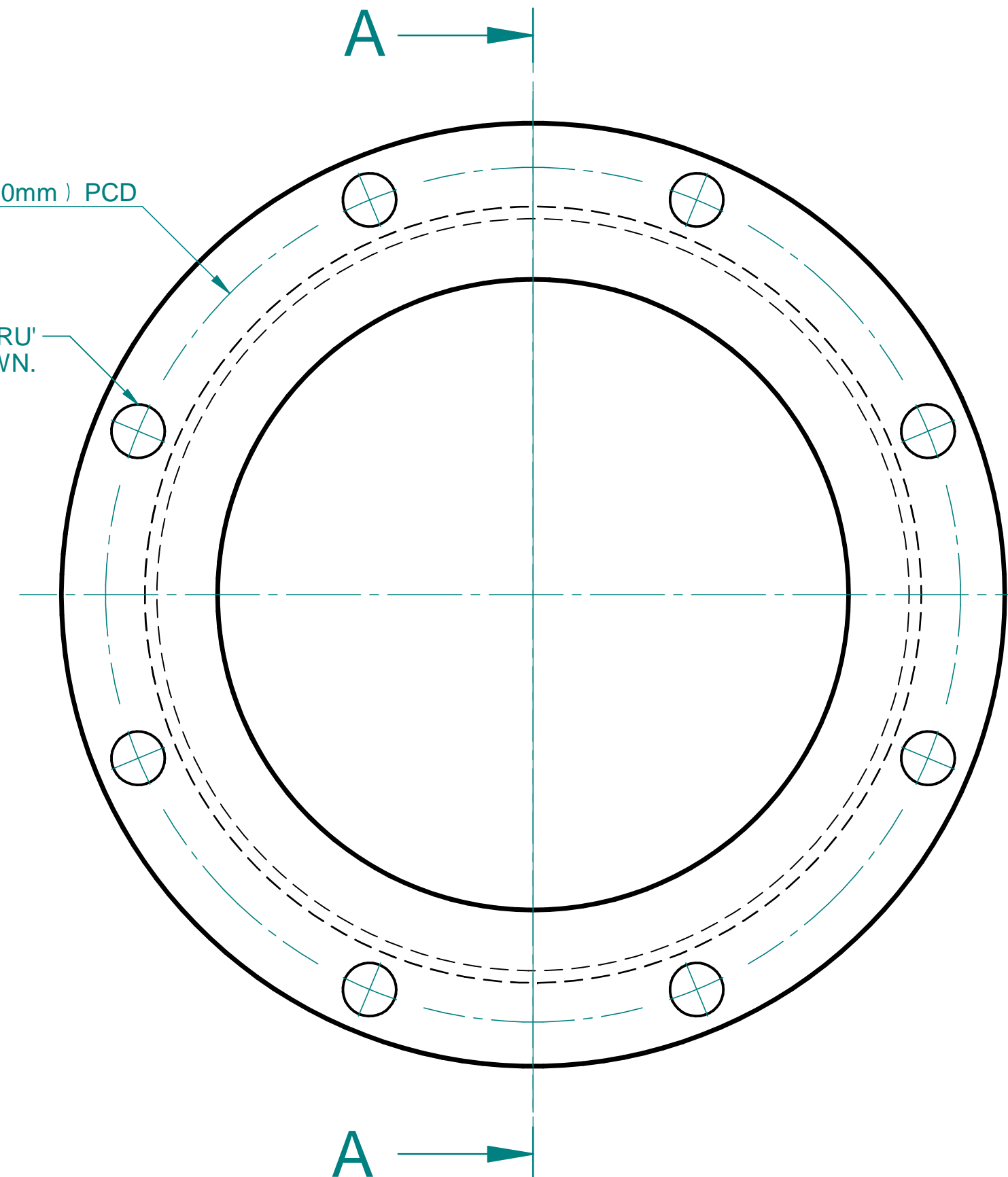

- NOTES:-**
 1. REMOVE SHARP EDGES.
 2. MASS=4.038 kg

| ISSUE | ECR No | DRN | AUTH | DATE |
|-------|--------|-----|------|------|
| B | | | | |
| C | | | | |
| D | | | | |
| E | | | | |
| F | | | | |
| G | | | | |
| H | | | | |



AESSEAL plc

BRADMARSH BUSINESS PARK
 MILL CLOSE, TEMPLEBOROUGH
 ROTHERHAM S60 1BZ

THIS DRAWING IS CONFIDENTIAL TO AESSEAL plc AND NEITHER THE DRAWING ITSELF, NOR ANY INFORMATION DERIVED FROM IT, SHOULD BE MADE PUBLIC, OR DIVULGED, EVEN IN CONFIDENCE TO ANOTHER PARTY WITHOUT THE EXPRESS PERMISSION OF AESSEAL plc. © COPYRIGHT AESSEAL plc AS SIGNED AND DATED.

UNSPECIFIED TOLERANCES

LINEAR: +/- 0.01" (0.25mm)

ANGULAR: +/- 30'

SURFACE FINISH: 63 µin (1.6 µm)

CONCENTRICITY: 0.002" (0.05mm)

TITLE: 127mm WARMAN BEARING END PLATE (153mm) SUITS EE NON-DRIVE END

| | | | |
|-----------------------------|---------------|-------------|--|
| PROJECTION 3RD ANGLE | SCALE | SIZE | MAT'L: 316L SS |
| | 1:1 | A2 | SRM: RT236/150 |
| DRAWN | ISABELLE BALM | 12/12/2022 | STOCK CODE: L1-153-02EE--WAR/01 |
| CHECKED | JOSHUA BANKS | 14/12/2022 | |
| DRG No 3209012 | | | ISS. A |

