

Bearing Protection Application Enquiry Form



Please complete the fields below. Once completed, follow the submission details at the end of the document.

Section 1: Customer Details

End Customer:	<input type="text"/>	Email:	<input type="text"/>
Distributor/Salesperson:	<input type="text"/>	Tel no:	<input type="text"/>
Location:	<input type="text"/>	Date:	<input type="text"/>
(web: dropdown) Industry:	<input type="text"/>		

Section 2: Machinery Application Details

Equipment Type:

Manufacturer:

Size/Model:

Sealing Location:

Speed (RPM):

Axial Movement (max)

Positive (State Figure):

Negative (State Figure):

Shaft Runout (T.I.R):

Shaft to Bore Misalignment:

Shaft Orientation:

Horizontal
Vertical Top
Vertical Bottom

Bearing Chamber Pressure:

Lubricant Type:

None
Grease
Oil Mist
Splashed
Submerged*

*If submerged, provide oil viscosity:

Temperature at Isolator:

Min: °C °F

Max: °C °F

Housing Type:

Seal Type:

Machine Modifications?

Food Contact Materials required?

Briefly describe the Application:

Section 3: Pump & General Details

ØA (Shaft Ø): <input type="text"/>	D (Maximum Insertion): <input type="text"/>
ØB (Housing Bore Ø): <input type="text"/>	E (Distance to Step): <input type="text"/>
ØC (First Obstruction): <input type="text"/>	F (First Obstruction): <input type="text"/>

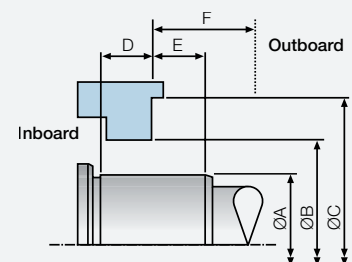

Section 4: Pillow Block Details

Inches mm

ØA1 (Shaft Ø):	<input type="text"/>	ØF (C'bore Ø):	<input type="text"/>
ØA2 (Sleeve Ø):	<input type="text"/>	G (C'bore Depth):	<input type="text"/>
ØB (Housing Bore Ø):	<input type="text"/>	H (Groove Minor width):	<input type="text"/>
ØC (Groove Ø):	<input type="text"/>	J:	<input type="text"/>
D (First Obstruction):	<input type="text"/>	K (Distance to Sleeve):	<input type="text"/>
E (First Obstruction):	<input type="text"/>	L:	<input type="text"/>

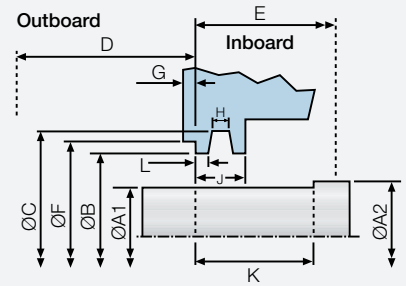

Section 5: ATEX Directive 94/9/EC Bearing Protectors ONLY

Most bearing protectors are classified as “Machinery Elements”, parts of machinery which do not fall under the ATEX directive 94/9/EC. ATEX certification is not required for “Machinery Elements”.

For details, see:

- a) https://single-market-economy.ec.europa.eu/sectors/mechanical-engineering/equipment-potentially-explosive-atmospheres-atex_en
- b) <https://www.europeansealing.com/about-us/position-statements/>

AESSEAL ATEX Addendum, together with the Application Limits sheet for the bearing protector type, provides all necessary information for the user to determine if the bearing protector is suitable for their ATEX application. Copies can be obtained by e-mail from atexlabtectas@aes seal.co.uk. Please state the bearing protector type(s) being considered.

5.1 Is ATEX certification required?

If **Yes**, please complete the below section. If **No**, go to section 6.2

ATEX information required (Mandatory)

Please note if ATEX certification is required further charges may be applicable

Group II Equipment Only

Zone:	1 (Cat 2)	2 (Cat 3)	
Gas or Dust:	Gas	Dust	Both

Temperature Class

T1 (450°C / 842°F)	T4 (135°C / 275°F)
T2 (300°C / 572°F)	T5 (100°C / 212°F)
T3 (200°C / 392°F)	T6 (85°C / 185°F)

Group I Equipment Only

ATEX Category:

5.2 Is ATEX evaluation required?

If **Yes**, please email: atexlabtectas@aes seal.co.uk. AESSEAL® Technical Dept will evaluate an ATEX application if provided with full application information and the ATEX specification for the plant area (e.g. EX II 2G IIC c T3).

Section 6: Additional Information

6.1 What is the customer currently using in the proposed application? (please tick below)

<input type="checkbox"/> Labyrinth	<input type="checkbox"/> Lip Seal	<input type="checkbox"/> Other	If Other , please specify: <input type="text"/>
------------------------------------	-----------------------------------	--------------------------------	--

6.2 What is the cost and lifetime of the existing sealing device?

6.3 How many identical units are there to seal if the first item proves successful?

6.4 Any additional information?

If you are a new customer, please click **SUBMIT**, or return to enquiries@aes seal.info.
Alternatively, send this to your local branch contact.